

ACR Balanced Flue Snorkel Kit for Gas Stoves

<https://www.calonyradref.co.uk/acr-gas-balanced-flue-snorkel-kit>

Designed to work with the ACR range of Natural Gas and LPG stoves, this balanced flue kit is designed for using the rear exit on the stove, to travel directly through the wall to the exterior of the property, requiring a snorkel setup.

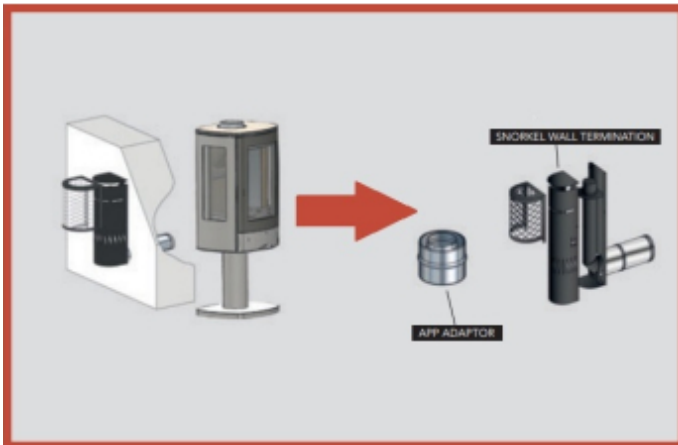

The kit comprises the spigot adaptor for the rear flue exit on the stove, and the snorkel kit which can pass through the wall up to 500mm.

Note: If your wall is more than 500mm thick or you require a taller length of vertical flue pipe, please get in touch with your requirements and we can liaise with ACR to achieve the result you're looking for.

View full info, images & specifications at:

<https://www.calonyradref.co.uk/acr-gas-balanced-flue-snorkel-kit>